



淮洋有限公司 HUI YANG CO.,LTD.

TEL : 886-2-8261-8986 FAX : 886-2-8261-1885

www.hy1688.com.tw 236新北市土城區中央路二段191號10樓之5

2TE

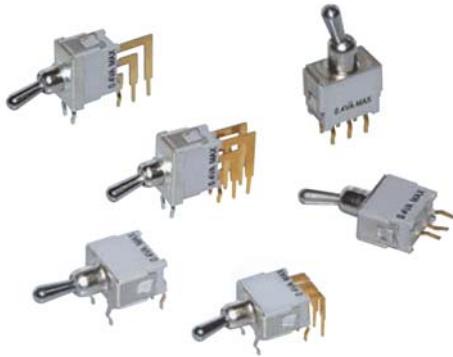

SPECIFICATIONS

CONTACT RATING: Max 0.4 VA max @ 48 VAC or DC

MECHANICAL LIFE: minimum 40,000 operations.

CONTACT RESISTANCE: 50 mΩ max.

INSULATION RESISTANCE: 1,000 MΩ min.

DIELECTRIC STRENGTH: 500 Vrms min. @sea level.

OPERATING TEMPERATURE: -20°C to 85°C.

DEGREE OF PROTECTION: IP67

MATERIALS

ACTUATOR: Brass,chrome plated,internal O-ring seal.
Standard for all actuators.

BUSHING & HOUSING: SPCC

CASE: Glass filled nylon 6/6, flame retardant,heat stablized
(UL94v-0)

SWITCH SUPPORT: Brass,tin plated.

CONTACT / TERMINALS: Phosphor bronze gold - plated
over nickel barrier.

TERMINAL SEAL: Epoxy



HOW TO ORDER

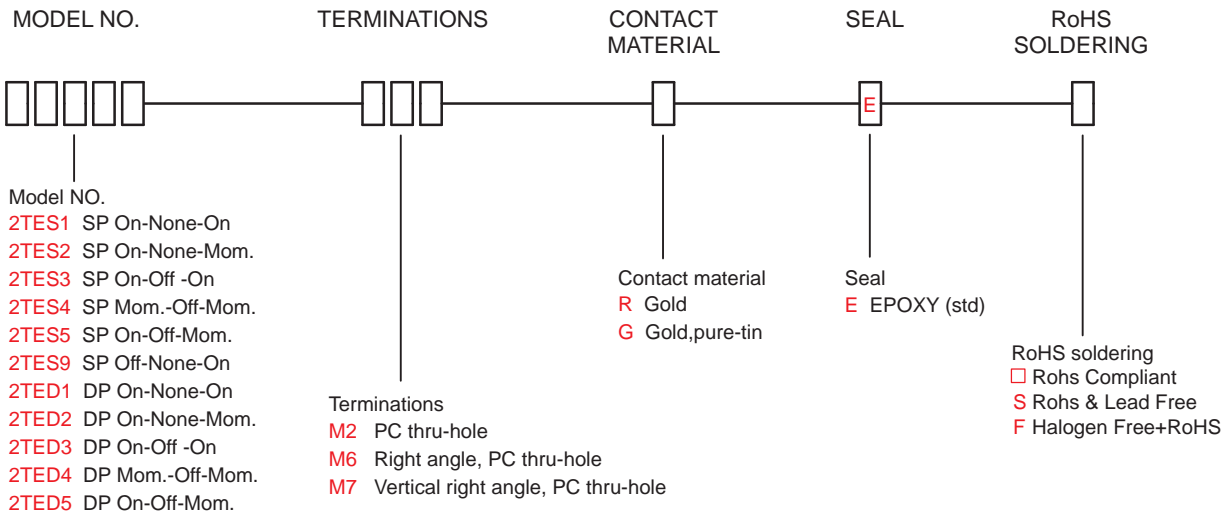

SWITCH FUNCTION

NO. POLES	MODEL NO.	SWITCH FUNCTION			CONNECTED TERMINALS / SCHEMATIC		
		POS.1	POS.2	POS.3	POS.1	POS.2	POS.3
SP	2TES1	ON	NONE	ON		N/A	
	2TES2	ON	NONE	MOM		OPEN	
	2TES3	ON	OFF	ON			
	2TES4	MOM	OFF	MOM	OPEN	N/A	2-1
	2TES5	ON	OFF	MOM			
	2TES9	OFF	NONE	ON	OPEN	N/A	2-1
DP	2TED1	ON	NONE	ON		N/A	
	2TED2	ON	NONE	MOM		OPEN	
	2TED3	ON	OFF	ON			
	2TED4	MOM	OFF	MOM	OPEN	N/A	2-1,5-4
	2TED5	ON	OFF	MOM			

MOM=MOMENTARY

POLE OPTIONS

M2

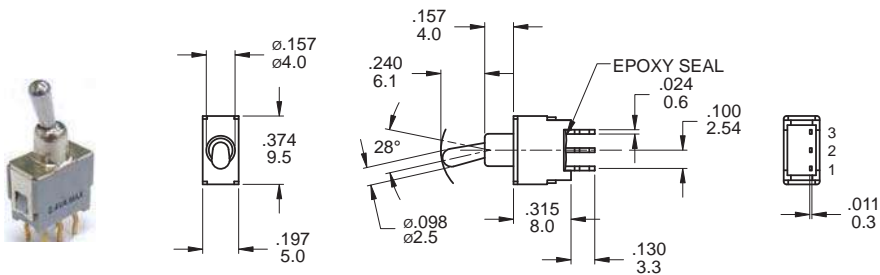

P.C. MOUNTING

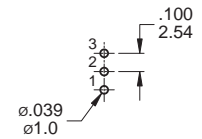

SPDT

Part No. Shown : 2TES1-M2RES

M2

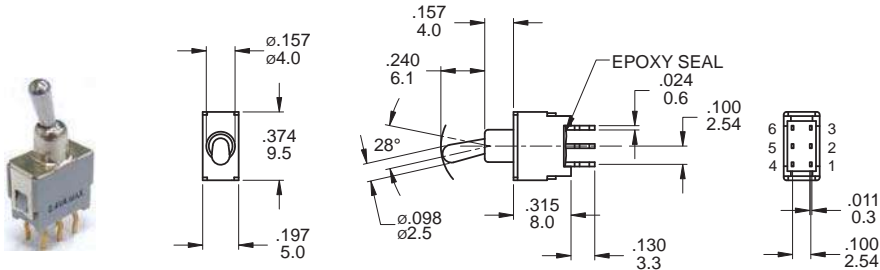

P.C. MOUNTING

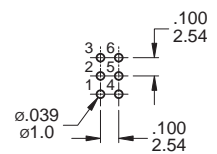

DPDT

Part No. Shown : 2TED1-M2RES

M6

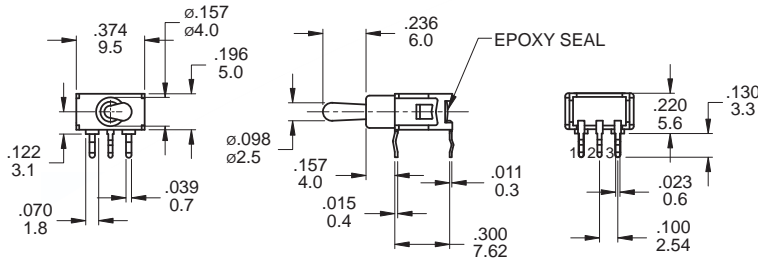

P.C. MOUNTING

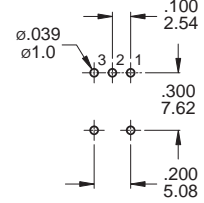

SPDT

Part No. Shown : 2TES1-M6RES

M6

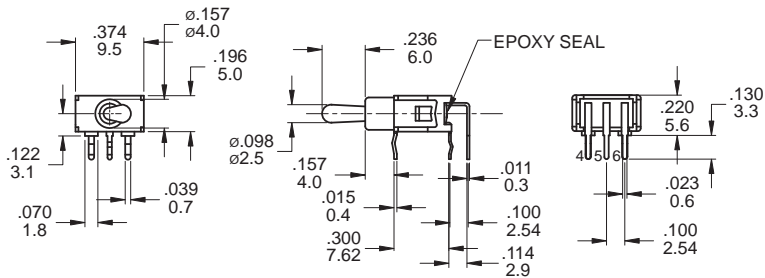

P.C. MOUNTING

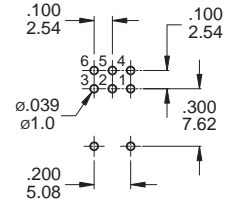

DPDT

Part No. Shown : 2TED1-M6RES

M7

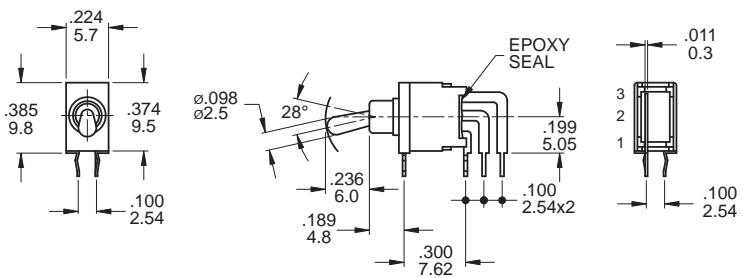

P.C. MOUNTING

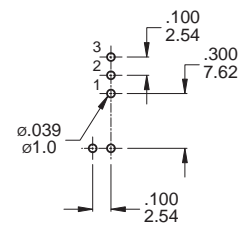

SPDT

Part No. Shown : 2TES1-M7RES

M7

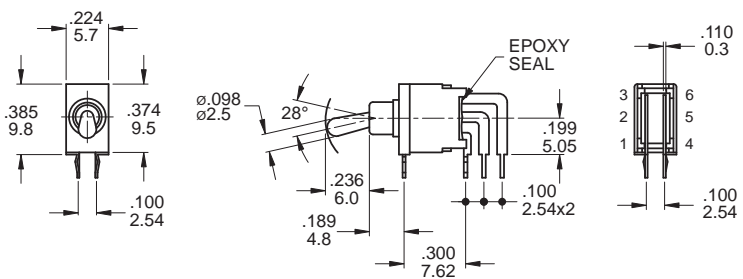

P.C. MOUNTING

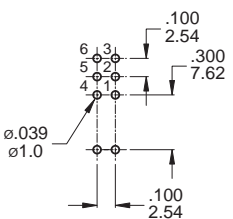

DPDT

Part No. Shown : 2TED1-M7RES

SOLDERING PROCESSES

WAVE SOLDERING: Recommended Soldering Temperature: $260 \pm 5^\circ\text{C}$

Duration of Solder Immersion: Max 5 sec.(PCB is 1.6mm in thickness)