

L21

SERIES SWITCHES

L21-22A2

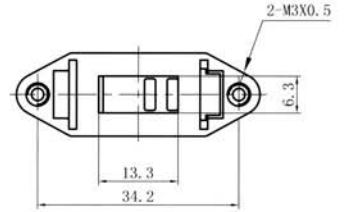
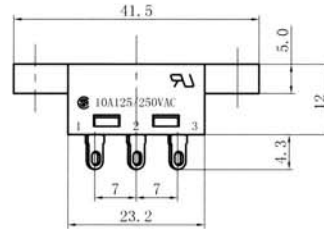
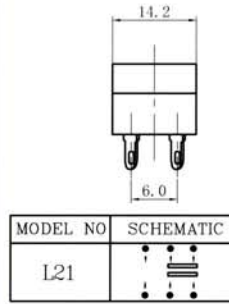

L21-22A1

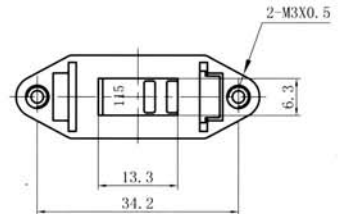
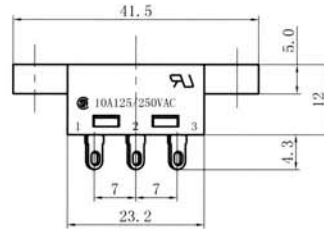
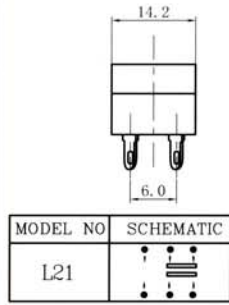

SPECIFICATION

Contact Rating :10A 125/250VAC ()
 :10(1)A 250V~μT85 ()
 Contact Resistance :50 milliohms max.
 Insulation Resistance :500 Megohms min. 500VDC

Withstand Voltage :2,000 VAC-1 minute
 Endurance :10,000 Cycles
 Operating Force :600±200gf

