

Feature -

Single key and multi - keys ,
Inter-lock available

Applications -

Consumer products , Instrumentation ,
Computer products ,
Communication equipment

► SPECIFICATIONS

SWITCH SPECIFICATIONS	
POLE - POSITION	2P2T , Lock , Momentary , Interlock Type
CONTACT RATING	30 V DC , 0.1 A
CONTACT RESISTANCE	40 mΩ max . 1.5 V DC ; 100 mA , by Method of Voltage DROP
INSULATION RESISTANCE	100 MΩ min . 500 V DC for 1 minute
DIELECTRIC STRENGTH	Breakdown is not Allowable ; 500 V AC for 1 Minute
OPERATING FORCE	200 ± 100 gf
OPERATING LIFE	10,000 cycles
OPERATING TEMPERATURE RANGE	-20°C ~ 70°C

► HOW TO ORDER

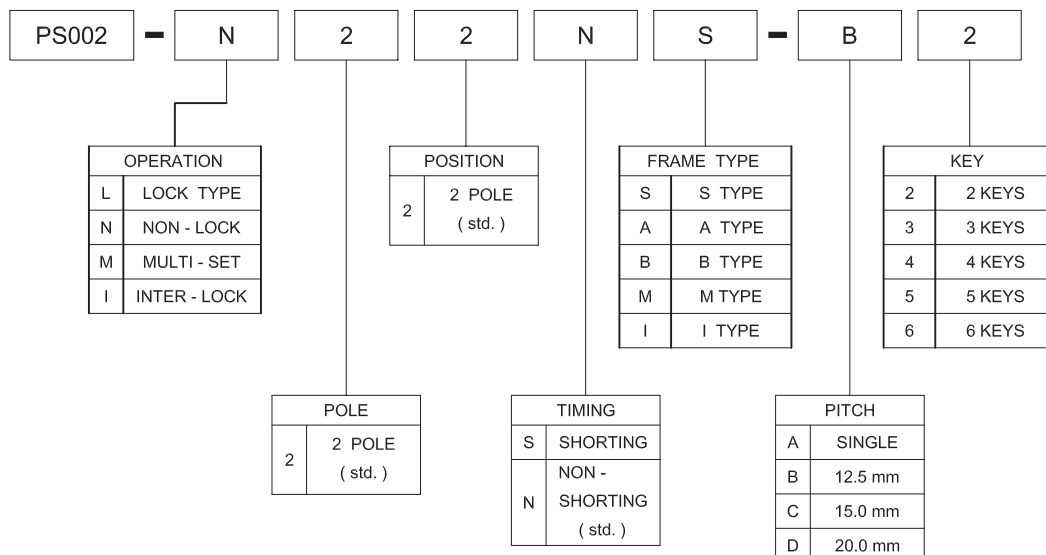

PS002 SERIES

PUSH BUTTON SWITCH

► DIMENSION

PS002 - N22NS

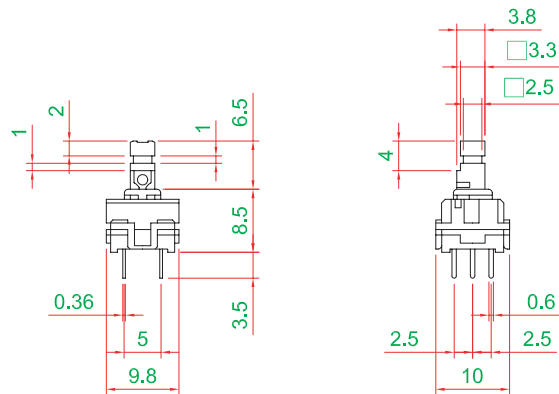

PS002 - I22NI

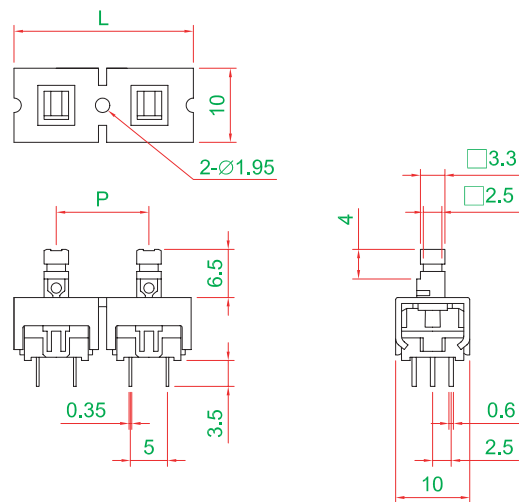
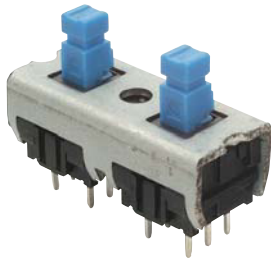

► FRAME TYPE / PITCH & KEY

S TYPE

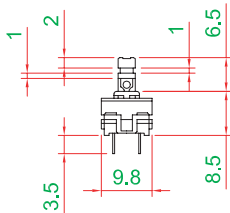

A TYPE

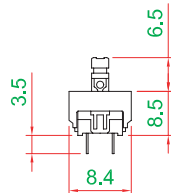

B TYPE

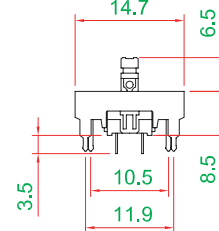

M / I TYPE

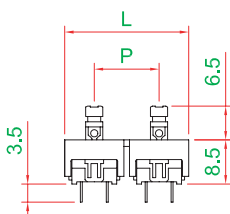

PITCH & KEY

No. of Keys		L					
		2	3	4	5	6	
P (PITCH)	A	SINGLE					
	B	12.5	27.5	40	52.5	65	77.5
	C	15	30	45	60	75	90
	D	20	35	55	75	95	115